

PipeFeeder DumpUnit

011-165-100

**Carrousel voersysteem
Carousel feeding system
Karussell-Fütterungssystem
Système d'alimentation sur roto**

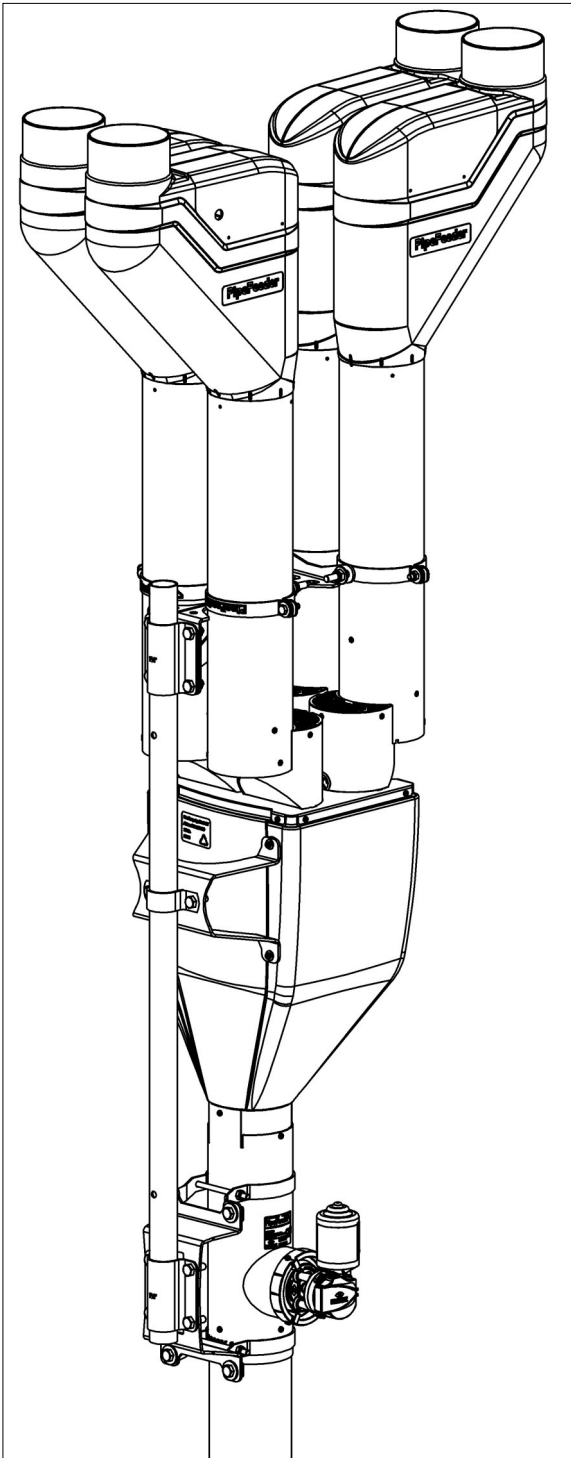

Installation and Operation Instructions

EN

Article number: 010-374-000

Date: February 2026

Version 1.4 - Translation of original Installation and Operation Instructions
According to Annex 1 Chapter 1.7.4 of the Machinery Directive 2006/42/EC



HANSKAMP

Innovation for dairy farming

Wehl,
The Netherlands
www.hanskamp.com

Foreword

Contents of the installation and operating instructions

This manual contains important information for the correct installation and operation of the Hanskamp DumpUnit. Read and understand this information thoroughly before configuration of the DumpUnit. Failure to do so could result in damage to the equipment. Please consult your local milking equipment dealer if you do not understand the information in this manual, or if you need additional information.

All information in this manual has been compiled with the greatest care. Hanskamp shall not be liable for errors or faults in this manual. The recommendations made are meant to serve as guidelines. All instructions, illustrations, and specifications in this manual are based on the latest information that was available at the time of publication. Your DumpUnit may contain improvements, features or options that are not covered in this manual.

Applicability

The table below shows the model numbers of the DumpUnit and the HighSpeed Pipe-Feeders to which this manual applies.

Model designation

| Model | Model number |
|--------------------------------------------|--------------|
| DumpUnit 4 kg, incl. wall bracket | 011-165-100 |
| PipeFeeder HighSpeed with outlet (max. 4x) | 029-XX0-0X0 |

Contact number of milking technology dealer

We recommend that you enter the name, phone number and e-mail of your milking technology dealer in the table below, so that you can always find the right information easily.

| | |
|------------------|--|
| Name | |
| Address | |
| Telephone number | |
| E-mail address | |

1. Introduction

With Hanskamp's DumpUnit, concentrate distribution in the carousel milking parlour becomes truly successful. The DumpUnit dispenses the desired amount of feed automatically and highly accurately when the cow enters the carousel. The benefit? Faster milking with significantly less feeding of concentrate. Hanskamp's DumpUnit is supplied with 1 limit switch as standard. The switch enables the DumpUnit to release the feed at exactly the right time. The DumpUnit is also equipped with the ingenious anti-spill system, which prevents feed pellets from falling into the trough after feeding has finished. This prevents cows from bumping against the DumpUnit.

The information in this manual is aimed at farmers and technicians.

- Dairy farmers use the information to test and adjust the DumpUnit.
- Technicians use the information to install and set up the DumpUnit.

2. Safety

2.1 Introduction

The safety alert symbol identifies important safety messages on your DumpUnit and in the manual. When you see this symbol, be alert to the possibility of personal injury or death. Follow the instructions of the safety message.



Safety alert symbol

2.2 Signal words

Note the use of the signal words **CAUTION** and **DANGER** with the safety messages. The signal word for each message uses the following guidelines:



Caution! Indicates a potentially hazardous situation which could result in minor personal injury or damage to equipment or the environment if the warning is ignored.



Danger! Indicates a potentially hazardous situation which could result in death or serious injury if ignored.

2.3 Safety instructions

You are responsible for the safe operation and maintenance of your DumpUnit. You must make sure that you and anyone else who is going to operate, maintain or work in the vicinity of the DumpUnit, knows all the related safety information in this manual.

You are the key to safety. Good safety practices protect you and the people around you. Make these practices a working part of your safety program. Make sure everyone who operates, maintains or works near the DumpUnit obeys the safety precautions. Do not risk injury or death by ignoring good safety practices.

- DumpUnit owners must train operators before they operate the DumpUnit. This training must be repeated at least annually.
- The operator must read, understand and obey all safety and operating instructions in the manual.
- Persons who have not read and understood all safety and operating instructions are not permitted to operate the DumpUnit.
- Do not modify the equipment in any way. Unauthorized modification may impair the function and/or safety and could affect the life of the equipment, and persons.
- Only use approved parts, and make sure they are only installed by authorized technicians.

2.3.1 General safety

- Make sure that you have read and understood the manual and the safety instructions before connecting the power supply to operate or adjust the DumpUnit, or turning it off for maintenance.
- Only trained personnel may operate the DumpUnit.
- Install all guards and safety devices before using the DumpUnit.
- Wear the appropriate personal protective equipment (PPE).
- Before cleaning the DumpUnit or performing maintenance on it, switch off the power supply of the DumpUnit by removing the plug from the socket.
- Make sure that phone numbers of emergency medical care available in your area are at hand.
- If you have any other questions, please contact your milking technology dealer.
- Review all safety-related topics with all users at least once a year.

2.3.2 Electrical safety

- Only a qualified electrician may install the DumpUnit power supply.
- Check whether the earthing of the electrical system and all parts of the DumpUnit comply with local rules and regulations.
- Replace any damaged electrical cables, cable sheaths, switches and parts immediately.
- Isolate or switch off the power supply before opening the lid of the DumpUnit and working on the electrical system.

2.3.3 Safety during installation

- Make sure that you have read and understood the instructions in this manual.
- Check whether the DumpUnit has been installed correctly, as described in the manual.

2.3.4 Safe operation

- Make sure that you have read and understood the manual and the safety instructions before connecting the power supply to operate or adjust the DumpUnit, or turning it off for maintenance.
- Only trained personnel may operate the DumpUnit.
- Before cleaning the DumpUnit or performing maintenance on it, switch off the power supply of the DumpUnit by removing the plug from the socket.
- Install the covers and guards before you operate the DumpUnit.
- Keep hands, feet, hair and clothing away from live parts.
- Keep all unauthorized persons, especially small children, away from the DumpUnit at all times.
- Before connecting the DumpUnit to the power supply, make sure that all parts are properly tightened and that all cables and mountings are in good condition.
- If you have any other questions, please contact your milking technology dealer.

2.3.5 Safety during maintenance

- Make sure that you have read and understood the manual and the safety instructions before connecting the power supply to operate or adjust the DumpUnit, or turning it off for maintenance.
- Only trained personnel may service and maintain the DumpUnit.
- Before cleaning the DumpUnit or performing maintenance on it, switch off the power supply of the DumpUnit by removing the plug from the socket.
- Wear protective clothing and safety glasses when working on the electrical system.
- Make sure all guards are installed when you have finished maintenance work.

2.3.6 Safety messages

- This chapter lists the general safety messages. Specific safety messages, where potential hazards may arise if the procedures or instructions are not followed, are included in the appropriate sections of this manual.

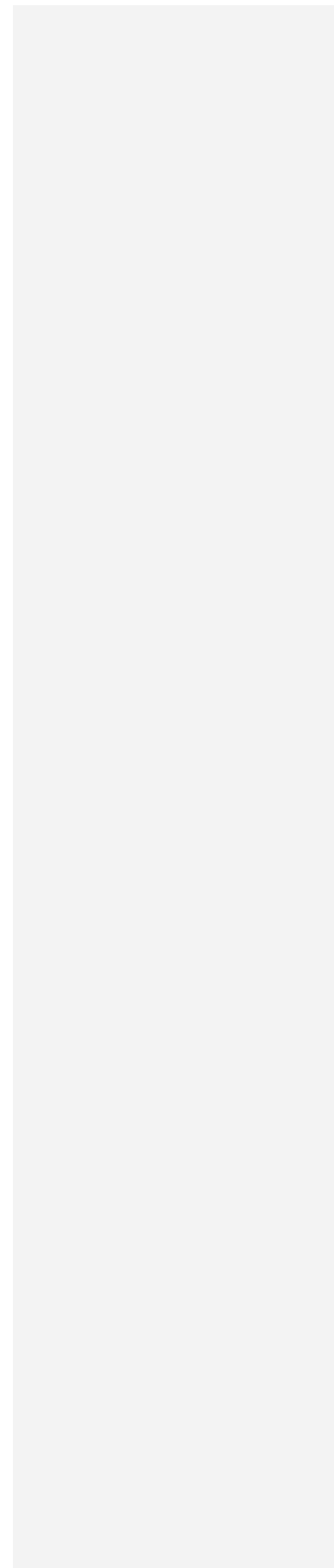

3. Installation and Operating Instructions

General description

The Hanskamp DumpUnit is an electrically operated dosing flap developed to dispense concentrate pellets in a rotary milking parlour (fig. 1). The DumpUnit is filled by 1 or more HighSpeed PipeFeeders. The PipeFeeders can be connected to the feeding computer or to Hanskamp's SmartPanel system, which also allows stand-alone feeding.

Part numbers and names for several components can be found in the appendix.

Transport and storage

The DumpUnit will be shipped in a cardboard box containing one DumpUnit. When shipping a complete milking parlour feeding system, all included boxes will be transported on a pallet. This pallet is completely sealed and the corners are covered with tape to prevent damage. The DumpUnit must be stored in the same way.

 **Caution! Always move the pallet using a suitable means of transport (forklift, pallet fork, pallet truck, etc.).**

 **Caution! Parts may fall off the pallet/out of the box when opening and unpacking the pallet/box.**

Safety stickers

The user and installer are responsible for operating and maintaining your DumpUnit safely. Safety stickers are used to ensure safety in and around the DumpUnit. See the graphics below for the correct positioning of the safety stickers.

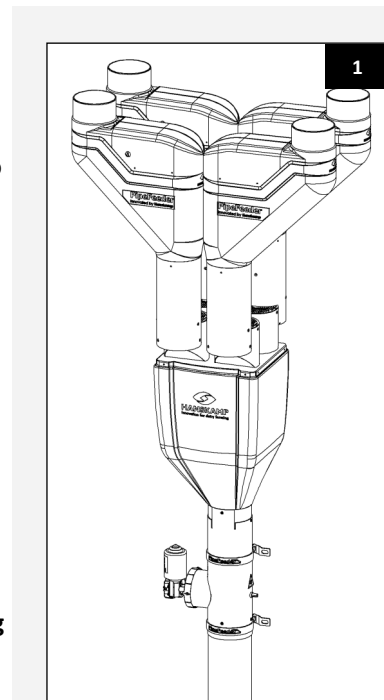

| | |
|---------------------------------------------------------|----------------------|
| Box contents: | |
| 1x PipeFeeder DumpUnit | art. no. 011-165-100 |
| 1x bag with 2 PipeFeeder clamps | art. no. 001-902-000 |
| 1x PVC down pipe, Ø 125 mm, l=850 mm | art. no. 011-163-000 |
| Variable number, length, colour and rotation, (max 4x): | |
| PipeFeeder HighSpeed | art. no. 029-XX0-0X0 |

Type descriptions, located above the cross tube.

Article number → Art.No: 029-000-000 **Serial number** → Serial No: 47160126

Product name → **PipeFeeder**
Innovated by Hanskamp

CE/UKCA marking → **DumpUnit**
Reverse Intelligent Motor | 1Kg - 4Kg
28RPM | PWR: 24V AC/DC | Puls: 24V AC/DC
Made in Holland

Contact details → **HANSKAMP** Hanskamp AgroTech bv
Innovation for dairy farming The Netherlands
info@hanskamp.nl
www.hanskamp.nl

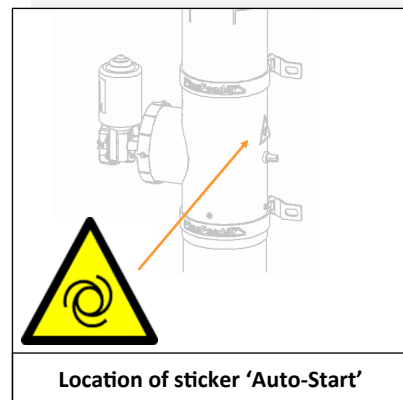
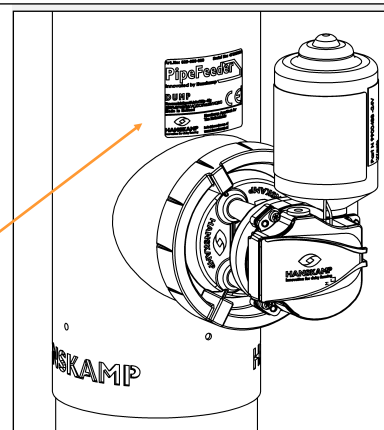

Applying the stickers

- Make sure the surface is dry and clean.
- Make sure the surface temperature is at least 5 °C.
- Find the right position for the sticker.
- Remove a small portion of the foil on the back.
- Place the sticker on the surface and press a small portion of the self-adhesive layer onto the surface.
- Carefully remove the foil and press down the rest of the sticker.
- Remove any air bubbles with a needle and use the foil to smoothen the sticker.

Maintaining stickers

- Keep safety stickers clean and legible.
- Clean safety stickers with soap and water.
- Do not use solvents or abrasives that could damage safety stickers.
- Replace missing or illegible safety stickers.

Safety stickers are available from Hanskamp. Always use the product numbers in correspondence.

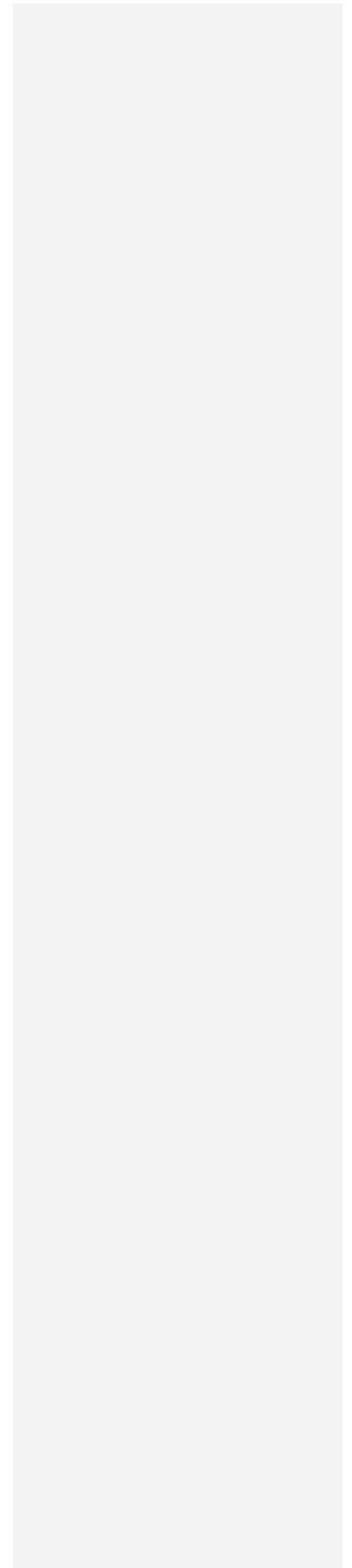

Installation

1. Insert the dosing flap (art. no. 011-155-000) into the down pipe and slide the slotted axle (art. no. 001-159-000) through the slide bearing, locking the flap in place (fig. 2).



Caution! Make sure the dosing flap is in a horizontal position when installing the motor. The arrow lasered in the gear runs parallel to the flap and must point horizontally to the left or right (fig. 3).

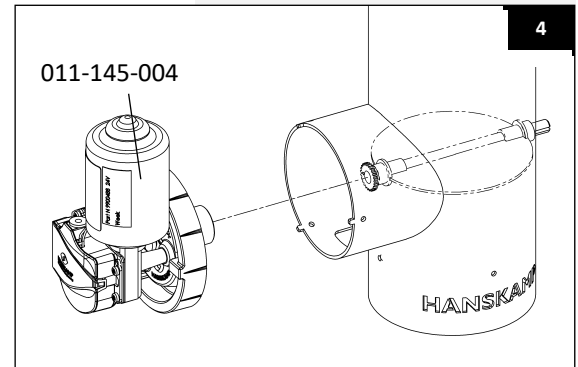
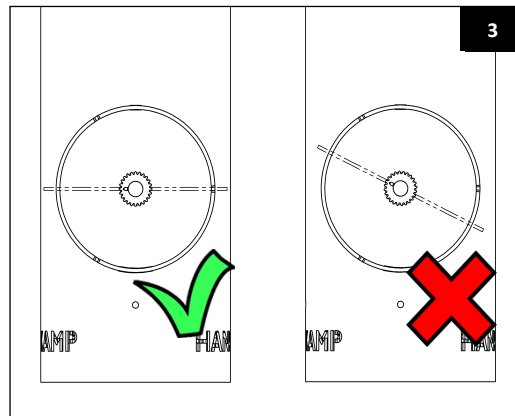
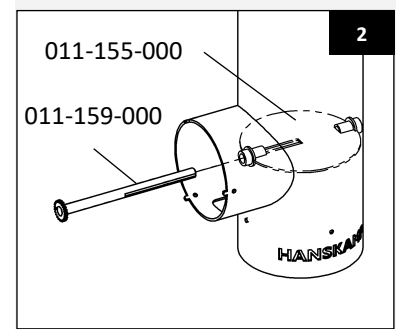

Caution! The coupling is attached to the motor's driveshaft with thread locker.

2. Place the motor including motor plate and coupling (art. no. 011-145-004) on the cross tube. Make sure that the DumpUnit dosing flap remains in a horizontal position. The cams at the end of the cross tube fit into the recesses in the motor plate, preventing the motor from turning around the tube later on.
3. Secure the motor with the supplied self-drilling screws (art. no. 001-284-000) (fig. 5).
4. Push the axle towards the motor as far as possible.

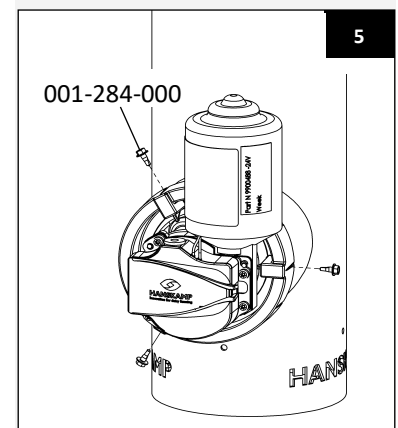

Caution! Check from underneath the down pipe, whether the dosing flap of the DumpUnit is closed. If this is not the case, repeat steps 2 and 3.

5. Insert a PVC pipe with a diameter of 125 mm (art. no. 011-163-000) and a length of at least 85 cm into the DumpUnit from below until it touches the cam in the DumpUnit. The cam is situated at the same height as the underside of the cross tube to prevent the PVC pipe (the down pipe) from being pushed up too high and to ensure free rotation of the dosing flap. The PVC pipe also prevents that one can come close to the moving parts (flap) in the down pipe (fig. 6).

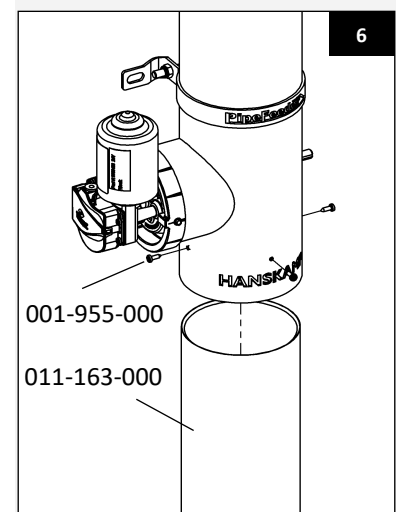

Danger! Always install a down pipe of at least 85 cm long or use other measures to prevent the risk of cutting.

6. Slide the adapter ring (art. no. 011-216-000) into the top of the DumpUnit, ensuring that the top of the adapter ring is flush with the top of the DumpUnit pipe (fig. 7).
7. Then the storage container (art. no. 002-055-000) can be pushed onto this tube. Secure the unit with 4 screws (art. no. 001-955-000).
8. Depending on the number of feed types, a cover plate (art. no. 011-247-000) must be installed on top of the container of the DumpUnit. Secure the cover plate with screws (art. no. 001-955-000). We recommend sealing the cover plate against dust with silicone sealant. Break out a half moon from the cover plate for each type of feed.
9. Mount the DumpUnit to a wall or on a frame, using the cross clamps (art. no. 001-909-000) or tube clamps (art. no. 001-058-000). For safety reasons, ensure that the DumpUnit is mounted at least 80 cm above the feed trough (fig. 11).



Caution! No additional wall-mounting material is supplied for wall mounting or chain/tube mounting.

10. Place the PipeFeeder HighSpeed on top of the DumpUnit. Insert the extensions of the PipeFeeder HighSpeed into the half moons in the cover on top of the container of the DumpUnit (fig. 9 & 10). Attach the PipeFeeders (max. 4 pieces) to the mounting block (art. no. 011-263-000) using the threaded clamps from the set supplied (art. no. 011-102-001). Make sure that the mounting block is positioned at 3/4 of the height of the pipe, so that it forms a solid whole. Be sure to fix the PipeFeeders in a vertical position using a spirit level when tightening the clamps.

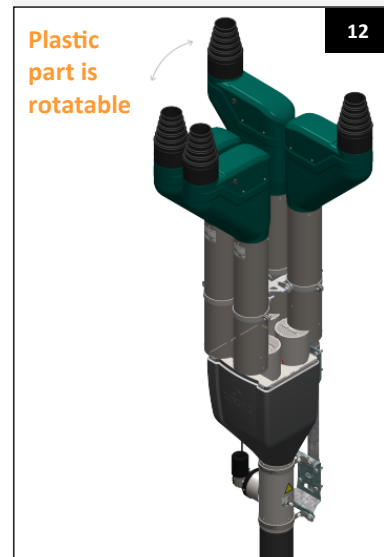
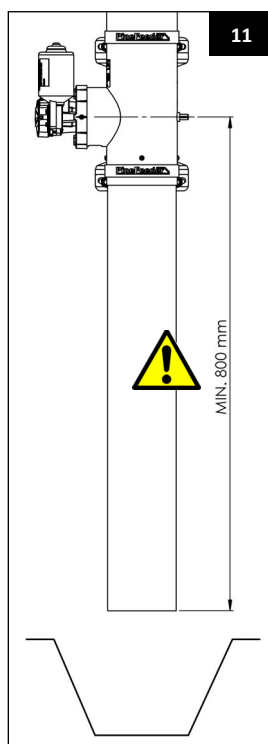
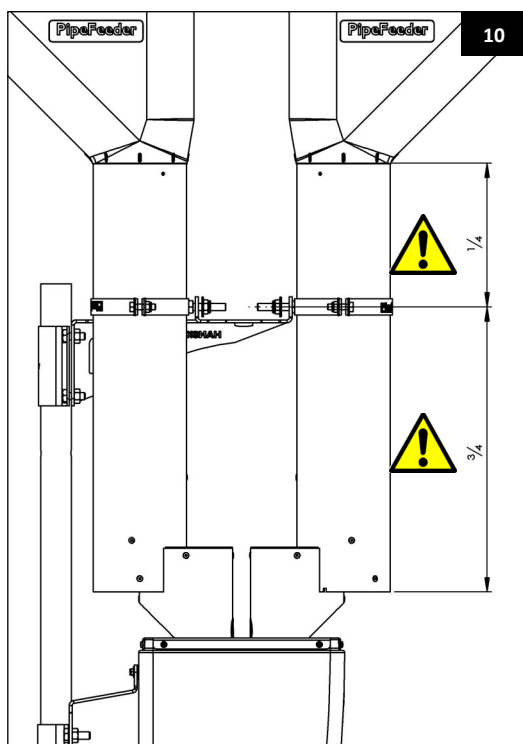
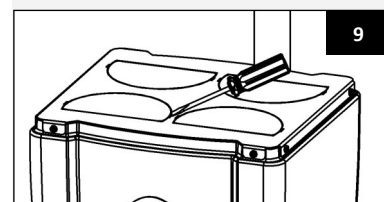
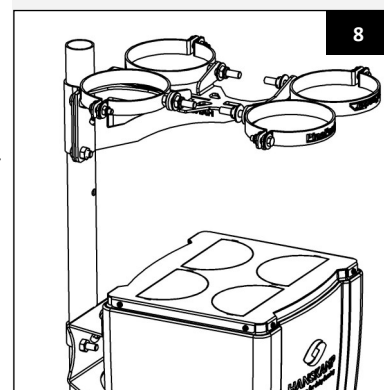
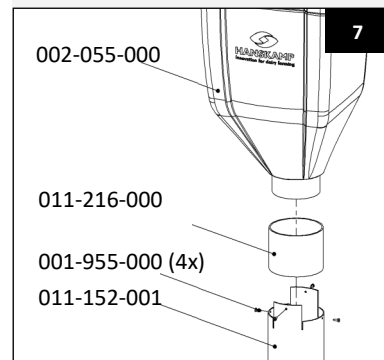

Electrical connection

The DumpUnit is powered by 24 V AC/DC and is activated by a limit switch (art. no. 011-150-000). The limit switch must be positioned in such a way that it switches as soon as the feed trough moves under the down pipe. The entire supply in the down pipe will then be released into the feed trough at once. If 24 V AC/DC is not available, you can order the Hanskamp PowerUnit 24 V DC 10A with power boost (art. no. 002-812-000). The corresponding connection diagram is shown below.

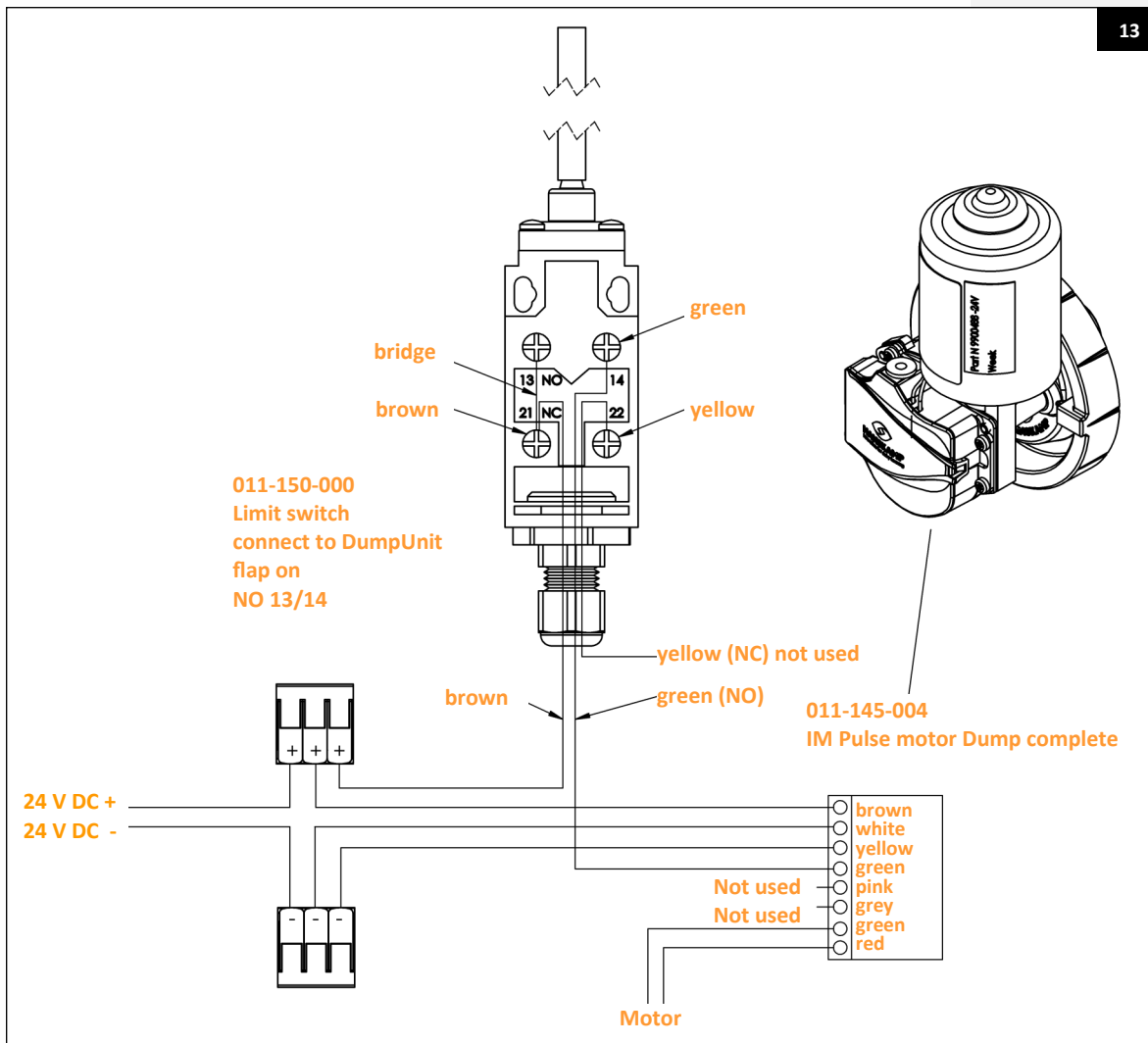

Danger! When connected to the power supply, the dosing flap of the Dump-Unit will start to rotate as soon as the limit switch is actuated.

PipeFeeder HighSpeed electrical connection

The PipeFeeders are controlled via the respective feeding computer of the rotary milking parlour. Hanskamp advises to always work with a MotorController to ensure the functioning of the motor and to enable the most accurate dosing possible. For more information, please refer to the MotorController's operating instructions and chapter 5 of this manual.



Caution! Make sure that the cumulative dosing time of the PipeFeeders does not exceed 10 seconds. If the PipeFeeders HighSpeed are activated for longer, the reservoir will overflow, causing it to block the dosing flap which can then no longer rotate.

Control stand-alone

It is also possible to control stand-alone (without feeding computer) by connecting the PipeFeeder HighSpeed to a Hanskamp SmartPanel control. More information about this can be found in the relevant manual and in chapter 5.

Caution!

The PipeFeeder is only suitable for cylindrical concentrate feed with a diameter of 4 to 6 mm and a minimum of 80% dry matter. The manufacturer cannot guarantee proper functioning with feed of other shapes or dimensions.



When installing the PipeFeeder, make sure that the pressure of the concentrate on the feeder does not exceed 50 kg.

Never insert your hand into the bottom of the PipeFeeder when it is still in operation or is connected to the electrical power supply.

Maintenance

1. Check the PipeFeeder DumpUnit installation daily for faults and wear. Do this by means of a control test on the feed motors, using the limit switch. Make sure that possible operating noises and vibrations caused by the PipeFeeder are reduced or eliminated as much as possible.
2. If the DumpUnit needs maintenance and is connected to a control unit, ensure that the DumpUnit cannot start unexpectedly. Make sure there is no voltage on the installation! To do this, completely de-energise the system by disconnecting the power supply to the control unit and the dosing motor.
3. It is recommended that repairs and maintenance be carried out by a specialist.
4. To avoid electric shocks or entrapment in the feed auger never open the housing while the DumpUnit is still running.
5. In the interest of the safety of all concerned, the user/owner of the DumpUnit is obliged to follow the recommendations and instructions given in the instruction manual. Failure to do so is the responsibility of the user. The manufacturer cannot be held liable in any way for injury or damage to or caused by the product.



Caution! Always disconnect the power supply to the system before carrying out maintenance work or disassembling the DumpUnit!

Cleaning

Clean the DumpUnit regularly with a moist cloth. Do not spray water under the cover or into the stock pipe. To guarantee proper functioning of the equipment make sure the outlet is clean and stays clean.



Caution! Do not use a high pressure cleaner in/on the PipeFeeder or the DumpUnit. This can lead to blockages in the system.

Disassembly

In case of disassembly, all parts must be separated according to material type and must be processed within the proper type of waste management system.



Warranty Limitations

Costs and expenses resulting from the following are excluded from the warranty:

- Using the equipment improperly, in violation of the specifications in the installation and operating instructions;
- The consequences of any intervention by mechanics other than mechanics approved by Hanskamp for carrying out certain work;
- Incidents such as freezing, ice, fire, flood, flooding or any other problems caused by excessive water, and lightning;
- Defective electrical system or earthing;
- Damage to the electrical system caused by pests and the like.

The warranty does not apply to consequential damages unrelated to the machine itself. All systems have been tested, However, in the event of defects, Hanskamp AgroTech BV cannot be held responsible for consequential damage.

Overview of changes made in these installation and operating instructions

| No. | Release date | Chapter(s) | Comments |
|-----|--------------|-------------------------|----------------------------------------------------------------------------------------------------------------------------------------|
| 1 | 04/2022 | | First release |
| 1.1 | 01/2023 | Pages 7 + 14 | UKCA logo added |
| 1.2 | 12/2024 | Pages 10, 16, 17 and 18 | Pages 10, 16 and 18 Images 12, 14 and 16 have been replaced. Page 17 Sticker added to item number list. Pages 17 and 19 removed. |
| 1.3 | 12/2025 | Pages 1 + 19 | Page 1 Change of place name. Page 19 Change of address Hanskamp. |
| 1.4 | 02/2026 | Page 19 | Page (19) inserted for new image with DumpUnit container clamp and DumpUnit tube. |

Copyright and disclaimer

The information in this publication is for informational purposes only, and is not intended as a sales quote. The products offered may differ from the images. Any brand or product references in this manual are for identification purposes only. The company and product names mentioned in this manual are trademarks. No part of this publication may be reproduced or made public without the prior written consent of Hanskamp AgroTech BV. Although this publication has been compiled with the greatest care, Hanskamp AgroTech BV is not liable for any damage that may arise due to any errors or omissions it might contain. The Dutch installation and operating instructions are the original installation and operating instructions. Translations into other languages are based on the Dutch installation and operating instructions as a source document. Hanskamp AgroTech BV accepts no liability for differences between the translations. If there are any doubts about the content and accuracy of the translated installation and operating instructions, the Dutch installation and operating instructions shall prevail.

Declaration of incorporation of complete machines IIA

According to Annex IIA of the Machinery Directive 2006/42/EC, for completed Machines

We,
Hanskamp AgroTech BV
Broekstraat 17
7009 ZB Doetinchem
The Netherlands,

Authorised compiler(s) of the technical file:

H.J. Hanskamp,

declare under our sole responsibility that the following product:

011-165-100 PipeFeeder DumpUnit,
Control unit and dosing unit for various carousel feeding systems from Hanskamp AgroTech BV,

to which this declaration relates, complies with the provisions of the following directives:

- Machinery Directive 2006/42/EC
- EMC Directive 2014/30/EU

The product also complies with the provisions of the following standards:

- NEN-EN 349
- NEN 5509
- NEN-EN-ISO 12100
- NEN-EN-IEC 60204-1
- NEN-EN-ISO 13857

If the PipeFeeder DumpUnit is not connected and the prescribed safety instructions are not used, this Declaration of Conformity is not applicable and no rights can be derived from this declaration.

Doetinchem, the Netherlands, 01-04-2022

H.J. Hanskamp



4. FAQ

| Common problem | Possible cause | Solution |
|----------------------------------------------|--------------------------------------------------------------------------------------------------|------------------------------------------------------------------------------------------------------------------------------------|
| No feed dispense. | No feed in stock pipe. | Check auger and silo. |
| | Motor is not controlled by the controller. | Remove the cover of the motor and check the LEDs on the PCB. Check power supply and control (voltage). |
| | Check if the dosing flap is spinning. No connection between rotor and motor with coupling piece. | Remove the motor from the dosing flap and reinstall it. Note the correct setting for the anti-spill function. |
| | Blockage by e.g. wood or plastic. | Remove the DumpUnit from the wall and shake it empty. It should be possible to rotate the flap by hand when the DumpUnit is empty. |
| DumpUnit flap is spilling. | DumpUnit flap has been adjusted incorrectly. | For readjustment, see page 9. |
| DumpUnit does not dispense the right amount. | Calibration of the PipeFeeder HighSpeed is incorrect. | Calibrate the controller. |

5. Extra options

For optimum operation of the system or to extend the functions, additional options can be added to the system.

MotorController

Hanskamp controller between HighSpeed motor and feed computer. Helps the motor start up and slow down for extra accuracy. Equipped with a replaceable motor fuse. Available for one (art. no. 002-816-000), two (art. no. 002-817-000), three (art. no. 002-818-000) and four feed types (art. no. 002-819-000).

SmartPanel

Stand-alone Hanskamp steering coupled to a HighSpeed motor. No RFID/feeding computer needed. Helps the motor start up and slow down for extra accuracy. Equipped with a replaceable motor fuse. Different scales possible. Automatic start by means of a limit switch. Available for one (art. no. 002-345-123), two (art. no. 002-345-223), three (art. no. 002-345-323) and four feed types (art. no. 002-345-423).

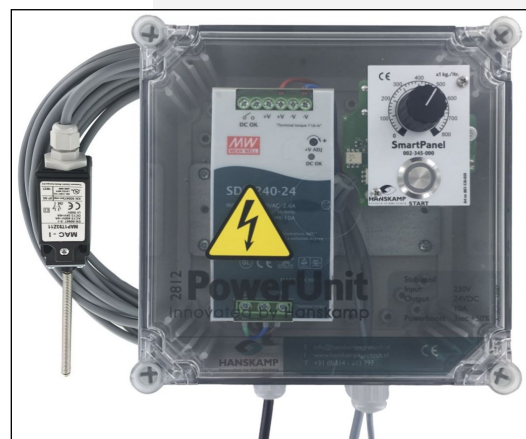

Individual parts PipeFeeder DumpUnit storage container (011-165-000)

For maintenance or other purposes, individual parts can be reordered through your milking equipment dealer. When doing so, please refer to the article numbers as indicated in the drawing below.

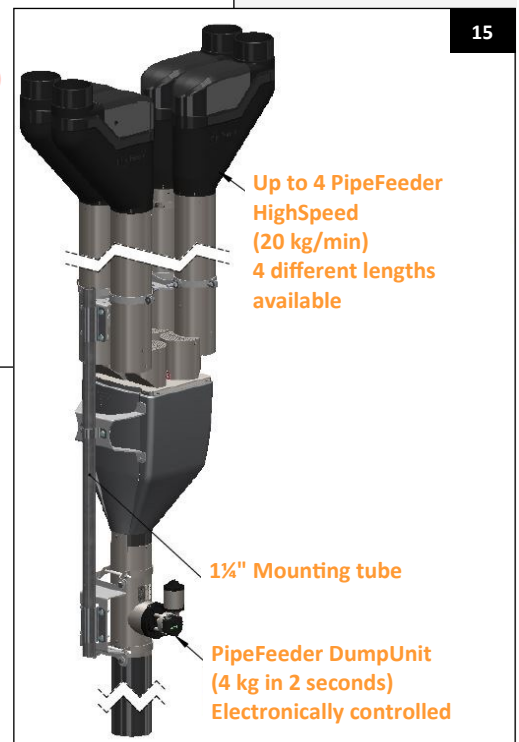
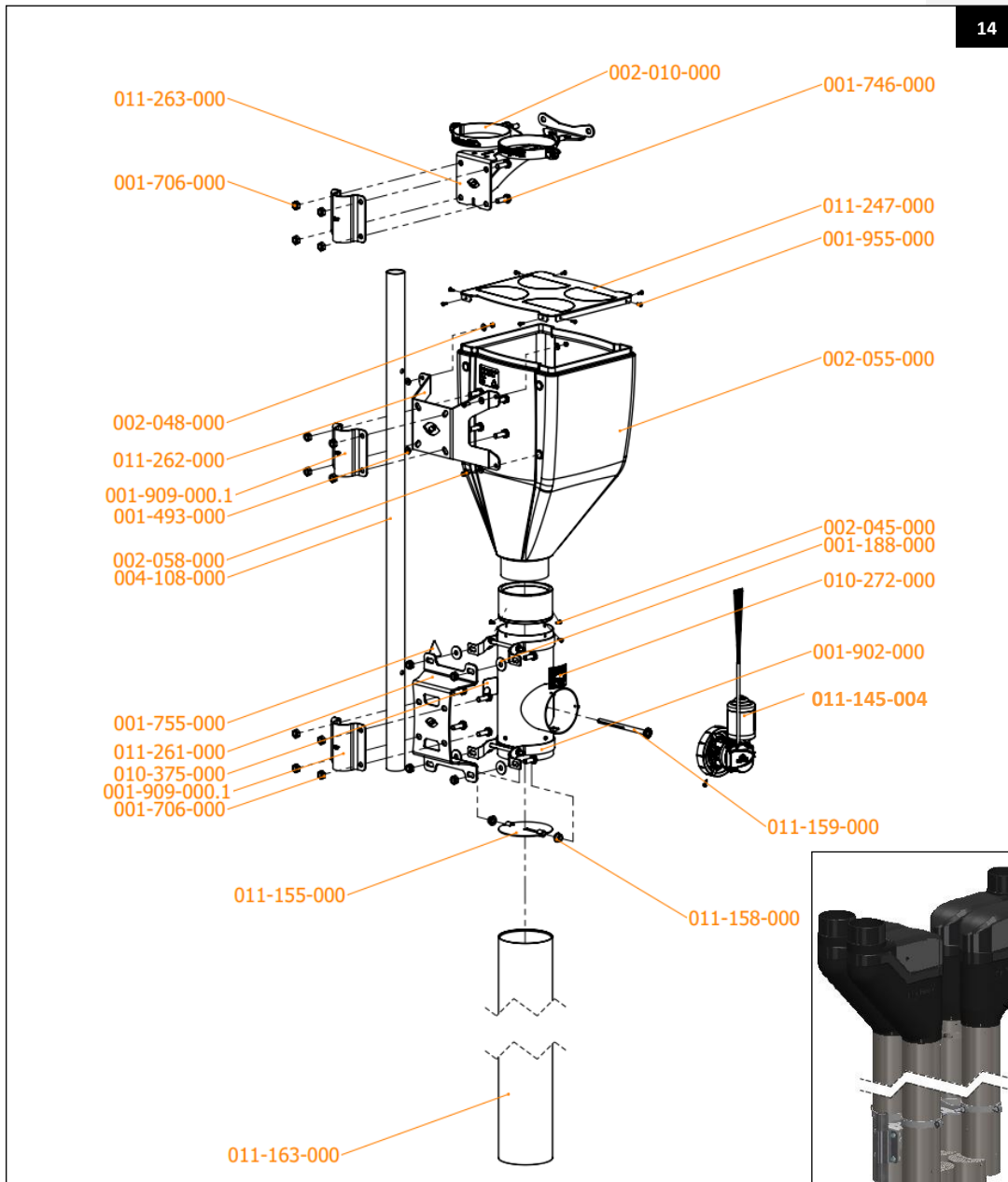

Description of parts - PipeFeeder DumpUnit 011-165-000 (figure 14)

| Article number | Description | Quantity |
|----------------|------------------------------------------------------------------------------|----------|
| 001-755-000 | Safety sticker 'Auto-Start' | 1 |
| 001-955-000 | Screw ckkk, 4 x 13 mm, A2 pozi, stainless steel | 15 |
| 002-045-000 | Screw ck, 4 x 16 mm A2, stainless steel | 4 |
| 002-055-000 | Storage container, white, 28 l - 17 kg | 1 |
| 002-060-000 | Mounting bracket clamp, Ø 129 mm, for PipeFeeder | 2 |
| 010-272-000 | Sticker serial number CE PipeFeeder Dump | 1 |
| 011-158-000 | Slide bearing, 10 x 12 x 21 mm, nylon, black, for Dump HighSpeed | 2 |
| 011-163-000 | PVC down pipe, Ø 125 mm, l = 850 mm, black, for PipeFeeder Dump | 1 |
| 011-216-000 | Adapter ring, 125 mm outer diameter x 110 mm | 1 |
| 011-247-000 | Cover plate storage container, 2 mm, stainless steel, for up to 4 feed types | 1 |
| 011-150-000 | Limit switch with flexible rod and cable gland, complete with 15 m cable | 1 |
| 011-145-004 | IM pulse motor Dump, 28 rpm | 1 |
| 011-152-001 | Pipe, Ø 129 mm x 2 mm, l = 400 mm, stainless steel, for Dump HighSpeed 1 kg | 1 |
| 011-155-000 | Dosing flap, stainless steel, for Dump HighSpeed | 1 |
| 011-159-000 | Shaft, Ø 10 mm, with gear, for Dump HighSpeed | 1 |

Description of parts - PipeFeeder DumpUnit incl. mounting bracket (additional parts)

| Article number | Description | Quantity |
|----------------|--------------------------------------------------------------------------------|----------|
| 011-261-000 | Spacer, 4 mm, sendzimir, for bracket PipeFeeder Dump | 1 |
| 011-262-000 | Spacer, 4 mm, sendzimir, for storage container | 1 |
| 011-263-000 | Mounting block, 4 mm, for 4 PipeFeeders HighSpeed, electrolytically galvanized | 1 |
| 001-909-000 | Cross clamp 1¼" x 1¼", 2-part, hot-dip galvanised | 1 |
| 001-746-000 | Bolt M10 x 30 mm DIN 933 8.8, electrolytically galvanized | 6 |
| 001-058-000 | Tube clamp, 1¼", hot-dip galvanised | 1 |
| 001-742-000 | Bolt M10 x 25 mm A2 DIN 933, stainless steel | 4 |
| 001-857-000 | Self-locking nut M10 A2 DIN 985, coated | 4 |
| 001-188-000 | Washer M10 x 30 x 2.5 mm DIN 9021, plastic | 4 |
| 002-058-000 | Tap bolt M5 x 16 mm A2 DIN 7985, PZ | 4 |
| 001-493-000 | Washer M5 x 15 x 1.2 mm, A2 DIN 9021 | 8 |
| 002-048-000 | Self-locking nut M5 A2 DIN 985, coated | 4 |
| 011-102-001 | Set with threaded clamps M10 for PipeFeeder + accessories | 2 |
| 004-108-000 | Hinge tube L'port, 1¼" x 2.6 mm, l = 1190 mm | 1 |
| 001-706-000 | Hexagon nut M10 DIN 934 8.8, electrolytically galvanized | 6 |
| 010-375-000 | Sticker | 1 |

Installation dimensions (figure 16)

| Heights PipeFeeders on DumpUnit | | | |
|---------------------------------|-------------|---------|--------------|
| No. | PipeFeeder | Height | Total height |
| 1 | Extra short | 789 mm | 2472 mm |
| 2 | Short | 1109 mm | 2792 mm |
| 3 | Normal | 1408 mm | 3091 mm |
| 4 | Long | 1894 mm | 3577 mm |

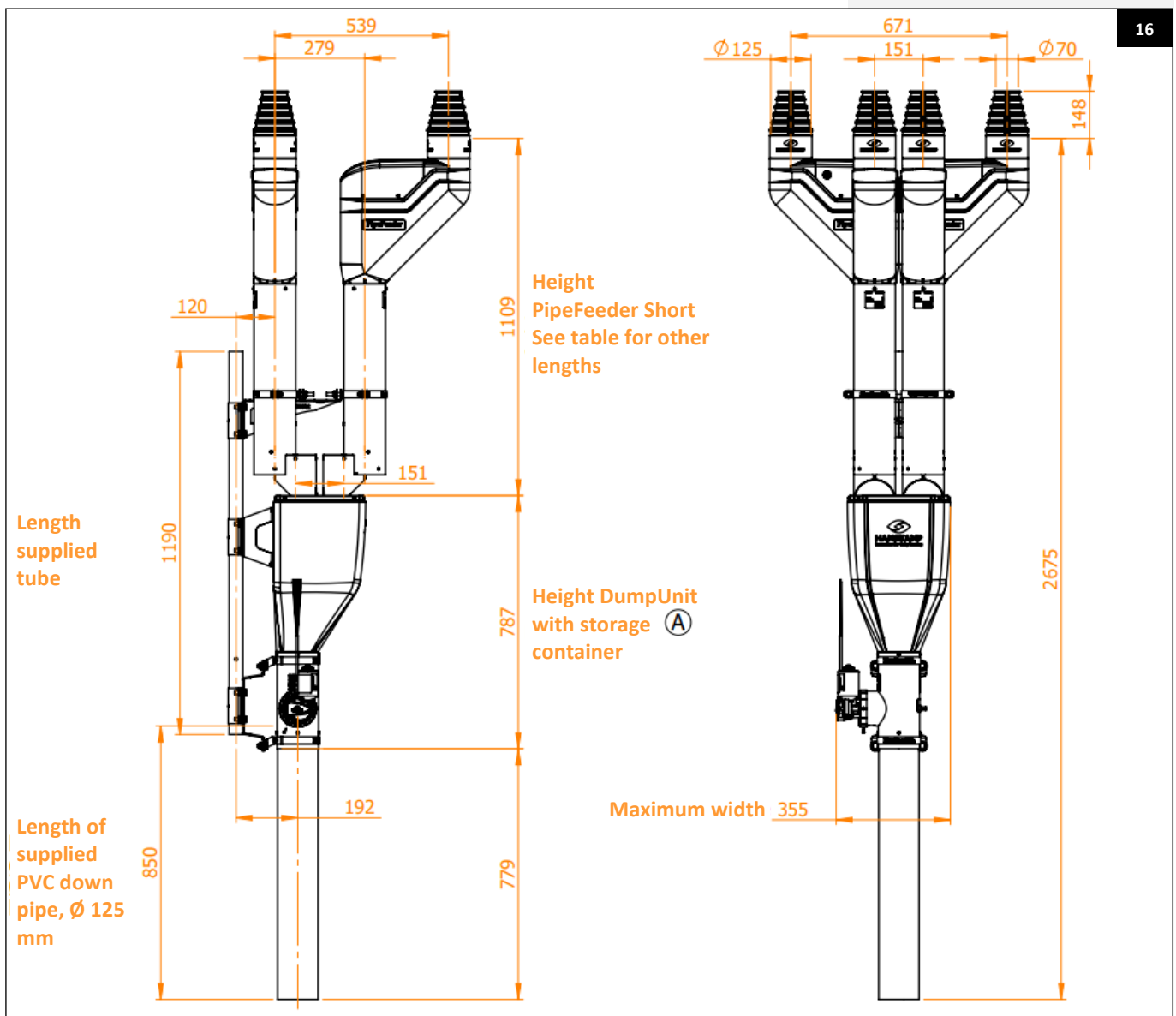

Dimensioned drawing for the installation hole centres of the DumpUnit mounting brackets

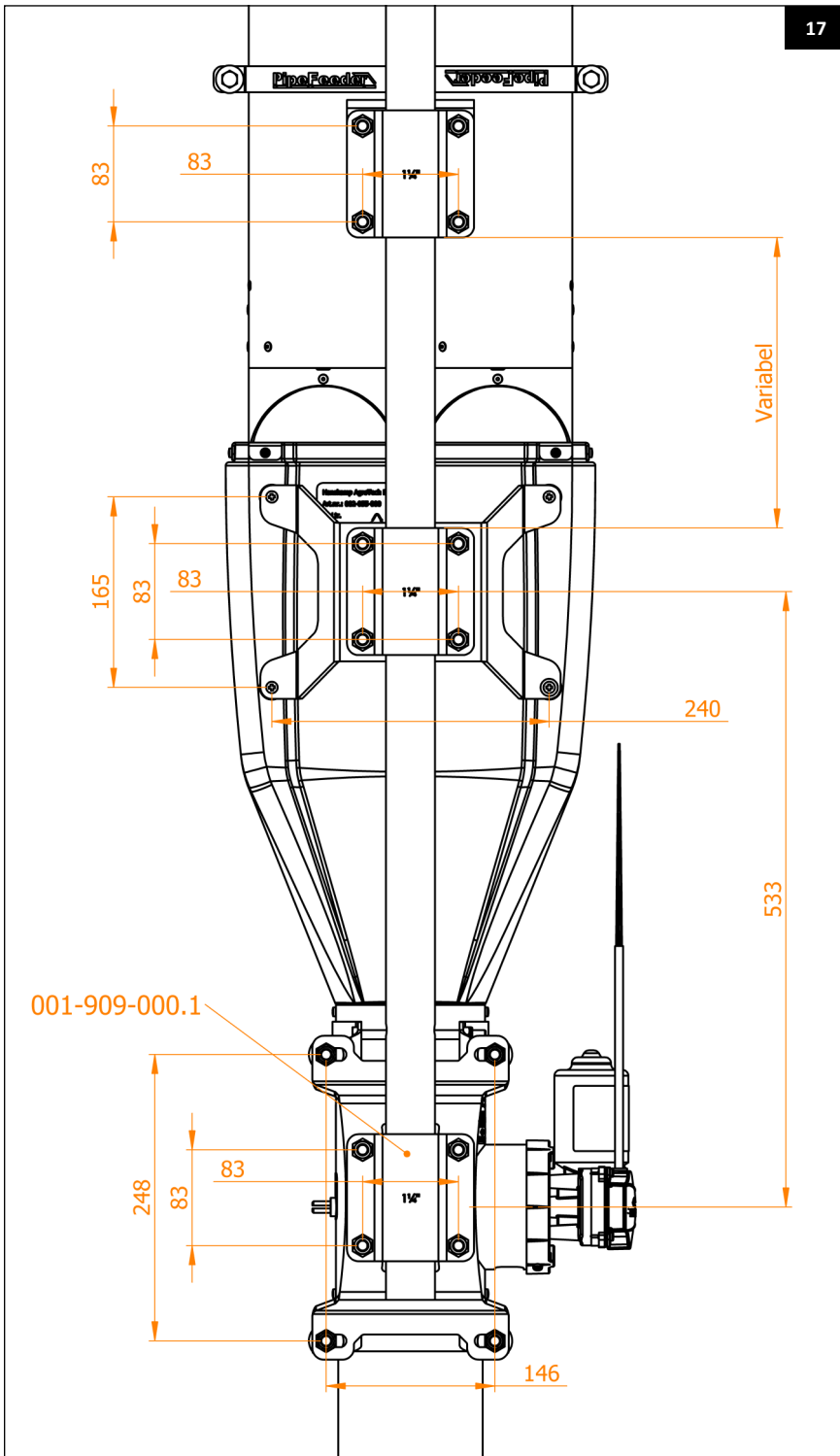

Hanskamp AgroTech BV
Xenonstraat 6
7031 HX Wehl
The Netherlands
Tel: +31 (0)314 - 393 797
www.hanskamp.com

Also take a look at:

